

### PRODUCTION FEATURES

- Manufactured in Europe from corrosion resistant Stainless Steel to EN 10088 / EN 10027-2 / 1.4404 (Marine Grade 316L)

### QUALITY FEATURES

- Full traceability for all components used in manufacturing process
- All components embossed with our manufacturers mark and Batch Number.
- All components are Proof Load Tested to 2.5 x W.L.L.
- Factor of Safety: 4:1
- Finish: Polished

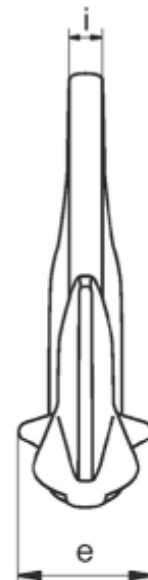
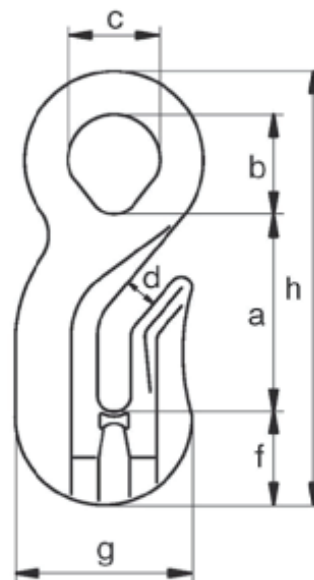

Part Code	Chain Size (mm)	Dimensions (mm)									W.L.L. (t)	Weight Each (Kg)
		a	b	c	d	e	f	g	h	i		
15-041-07/8	7/8	52	20	20	10	33	23	46	108	8	1.20	0.32
15-041-10	10	53	29	29	12	41	28	58	123	10	1.60	0.53
15-041-13	13	89	43	43	15	56	40	78	192	18	2.70	1.64